

# School of Medicine Floor Plan

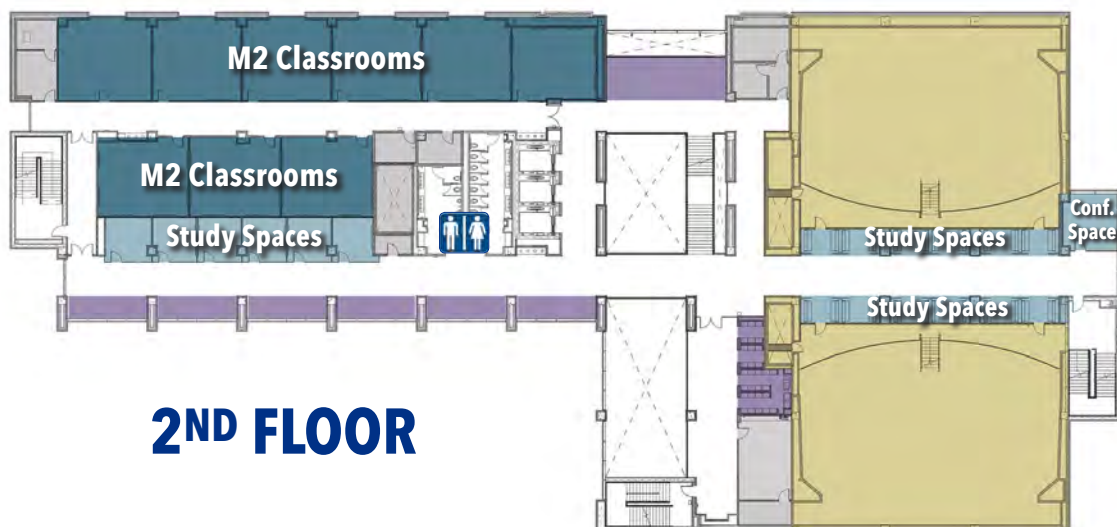

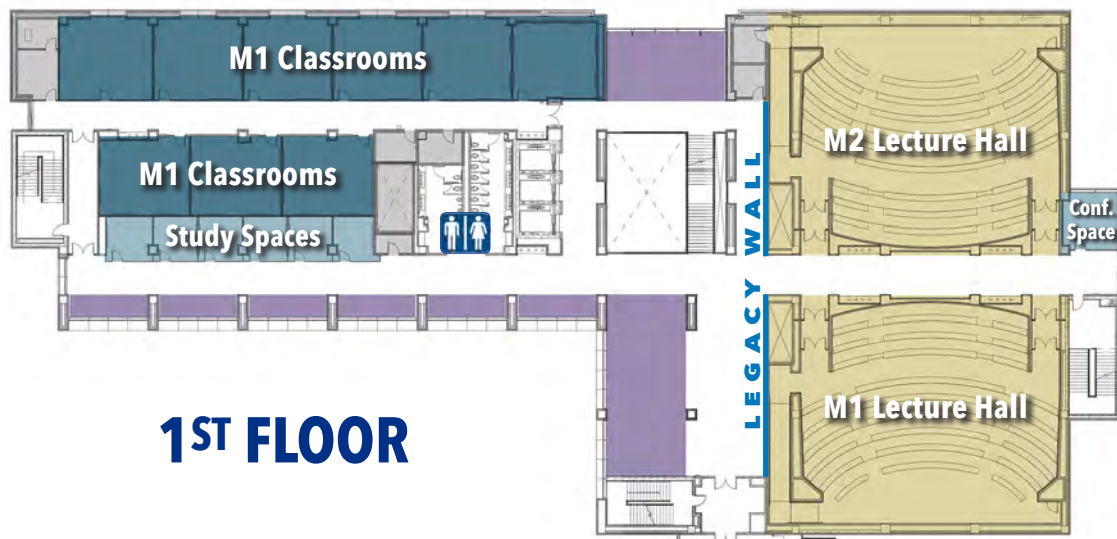

## 3RD FLOOR

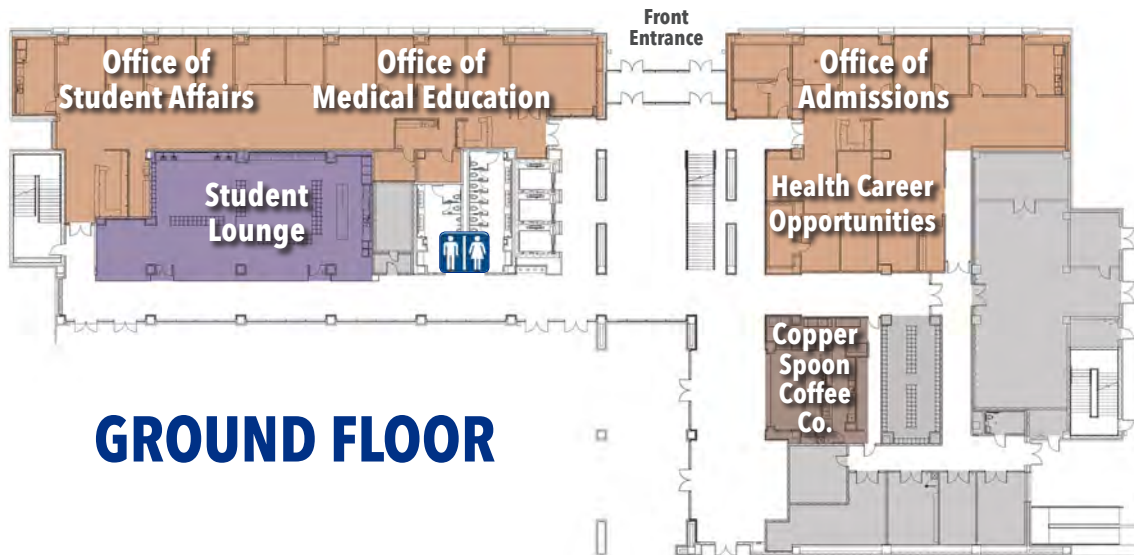
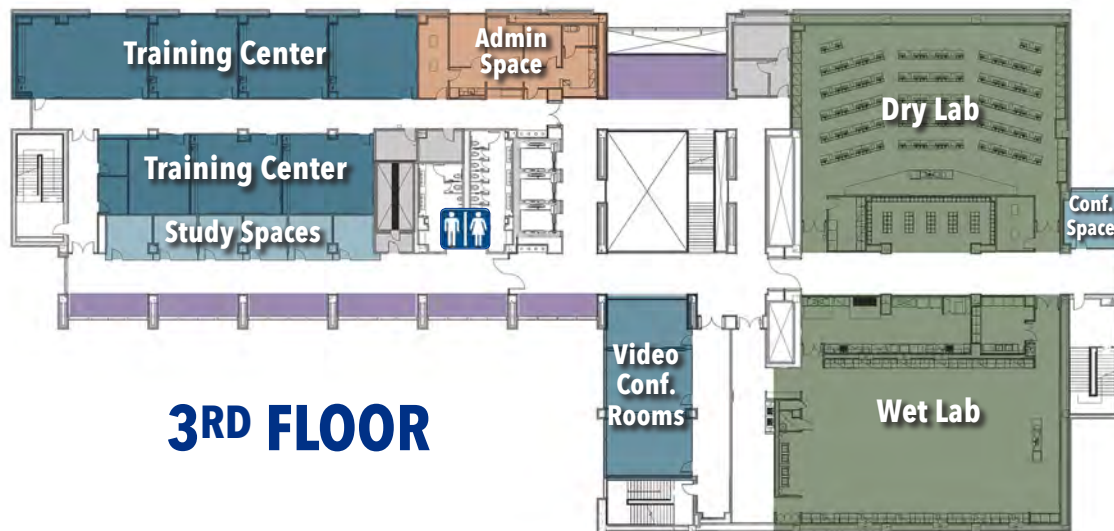
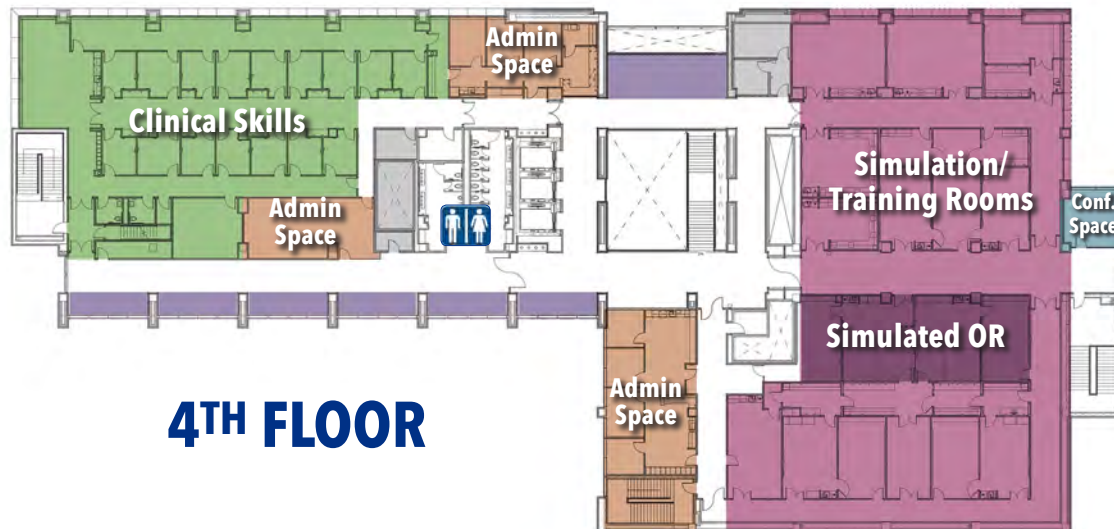

## 4TH FLOOR

# New School of Medicine Facts

**Groundbreaking:** January 7, 2013

**Dedication date:** August 4, 2017

**Campus location:** North side, between the Student Union and the Learning Resource Center

**Square footage:** Approximately 151,000

**Entering class size, fall 2017:** 155 students (capacity: approximately 165-plus)

**Architects:** Cooke Douglass Farr Lemons Architects and Engineers, P.A. and Eley Guild Hardy Architects, P.A.

**Contractor:** Roy Anderson Corp.

**Total cost:** \$73-\$74 million (includes state funds and a \$10 million Community Development Block Grant awarded through the Mississippi Development Authority and administered through the Central Mississippi Planning & Development District for site and infrastructure work)